

The Mayor Aldermen and Burgesses of the Borough of Keighley hereby confirm the foregoing Order as an unopposed Order under the provisions of Regulation 6 of the Town and Country Planning (Tree Preservation Order) Regulations 1969 made by the Minister of Housing and Local Government under Sections 29 and 217 of the Town and Country Planning Act 1962.

GIVEN under the Common Seal of the Mayor Aldermen and Burgesses of the Borough of Keighley this Eighteenth day of May 1973.

THE COMMON SEAL of the Mayor)
Aldermen and Burgesses of the)
Borough of Keighley was here-)
unto affixed in the presence)
of:-)

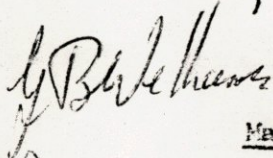

Mayor

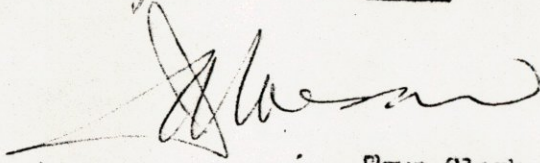

Town Clerk

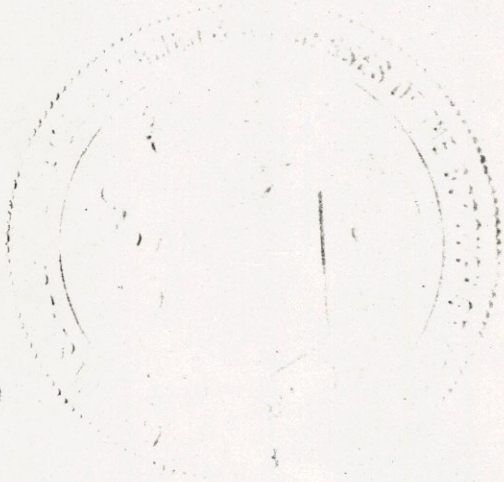

Originally had this as
TPO 156 agreed with
Daniel Speedy of TPO
Section 15 TPO 149
on 27/7/06

588 72/73

188
149
G
19/5/73

TOWN AND COUNTRY PLANNING ACT 1971

THE BOROUGH OF KEIGHLEY (TARNWOOD HOUSE) TREE
PRESERVATION ORDER 1973

WHEREAS the County Council of the West Riding of Yorkshire being the Local Planning Authority under the Town and Country Planning Act 1971 (hereinafter called "the Act") for the Administrative County of the West Riding of Yorkshire have entered into an Agreement with the Mayor Aldermen and Burgesses of the Borough of Keighley (hereinafter called "the Corporation") relating to the delegation of functions under the Act AND WHEREAS the aforesaid agreement authorises the Corporation to exercise (inter alia) the powers conferred upon the Local Planning Authority under the Act relating to the making of Tree Preservation Orders under the terms of Sections 60 and 61 thereof AND WHEREAS it appears to the Corporation that it is expedient to provide in the interests of amenity as hereinafter mentioned for the preservation of certain trees NOW THEREFORE on behalf of the County Council of the West Riding of Yorkshire (hereinafter called "the Authority") and in pursuance of the powers conferred in that behalf by Sections 60 and 61 of the Town and Country Planning Act 1971 and subject to the provisions of the Forestry Act 1967, the Corporation hereby make the following Order:-

1. In this Order -

"the Act" means the Town and Country Planning Act 1971;

"owner" means the owner in fee simple, either in possession or who has granted a lease or tenancy of which the unexpired portion is less than three years; lessee (including a sub-lessee) or tenant in possession, the unexpired portion of whose lease or tenancy is three years or more; and a mortgagee in possession; and

"the Secretary of State" means the Secretary of State for the Environment.

2. Subject to the provisions of this Order and to the exemptions specified in the Second Schedule hereto, no person shall, except with the consent of the Authority and in accordance with the conditions, if any, imposed on such consent, cut down, top, lop, or wilfully destroy or cause or permit the cutting

KEIGHLEY BOROUGH (Tarnwood House)

COUNTY COUNCIL OF THE WEST RIDING OF YORKSHIRE

TREE PRESERVATION ORDER NO 1 1973

0442

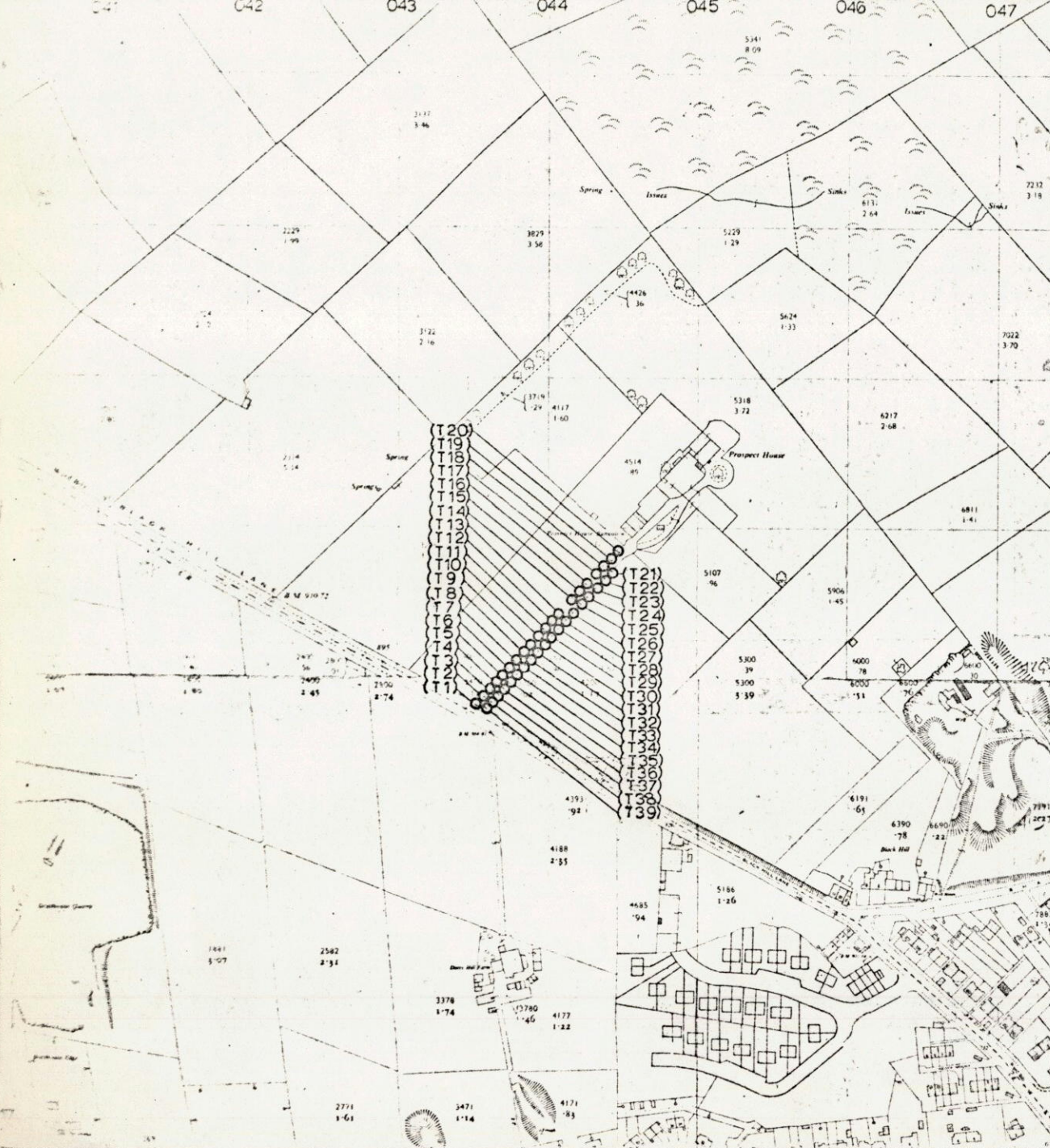

J. A. CAESAR, TOWN CLERK, TOWN HALL, KEIGHLEY.

down, topping, lopping or wilful destruction of any tree specified in the First Schedule hereto or comprised in a group of trees or in a woodland therein specified, the position of which trees and groups of trees and woodlands is defined in the manner indicated in the said First Schedule on the map annexed hereto which map shall, for the purpose of such definition as aforesaid, prevail where any ambiguity arises between it and the specification in the said First Schedule.

3. An application for consent made to the Authority under Article 2 of this Order shall be in writing stating the reasons for making the application, and shall by reference if necessary to a plan specify the trees to which the application relates, and the operations for the carrying out of which consent is required.

4. (1) Where an application for consent is made to the Authority under this Order, the Authority may grant such consent either unconditionally, or subject to such conditions (including conditions requiring the replacement of any tree by one or more trees on the site or in the immediate vicinity thereof), as the Authority may think fit, or may refuse consent:

Provided that where the application relates to any woodland specified in the First Schedule to this Order the Authority shall grant consent so far as accords with the principles of good forestry, except where, in the opinion of the Authority, it is necessary in the interests of amenity to maintain the special character of the woodland or the woodland character of the area, and shall not impose conditions on such consent requiring replacement or replanting.

(2) The Authority shall keep a register of all applications for consent under this Order containing information as to the nature of the application, the decision of the Authority thereon any compensation awarded in consequence of such decision and any directions as to replanting of woodlands; and every such register shall be available for inspection by the public at all reasonable hours.

5. Where the Authority refuse consent under this Order or grant such consent subject to conditions they may when refusing or granting consent certify in

respect of any trees for which they are so refusing or granting consent that they are satisfied:-

- (a) that the refusal or condition is in the interests of good forestry; or
- (b) in the case of trees other than trees comprised in woodlands, that the trees have an outstanding or special amenity value.

6. (1) Where consent is granted under this Order to fell any part of a woodland other than consent for silvicultural thinning then unless:-

- (a) such consent is granted for the purpose of enabling development to be carried out in accordance with a permission to develop land under the Act, or
- (b) the Authority with the approval of the Secretary of State dispense with replanting,

the Authority shall give to the owner of the land on which that part of the woodland is situated a direction in writing specifying the manner in which and the time within which he shall replant such land and where such a direction is given and the part is felled the owner shall, subject to the provisions of this Order and of the Act, replant the said land in accordance with the direction.

(2) Any direction given under paragraph (1) of this Article may include requirements as to:-

- (a) species;
- (b) number of trees per acre;
- (c) the erection and maintenance of fencing necessary for protection of the replanting;
- (d) the preparation of ground, draining, removal of brushwood, Top and top; and
- (e) protective measures against fire.

7. On imposing any condition requiring the replacement of any tree under Article 4 of this Order, or on giving a direction under Article 6 of this Order with respect to the replanting of woodlands, the Authority shall if such condition or direction relates to land in respect of which byelaws made by a river

authority or a drainage board restrict or regulate the planting of trees, notify the applicant or the owner of the land, as the case may be, of the existence of such byelaws and that any such condition or direction has effect subject to the requirements of the river authority or drainage board under those byelaws and the condition or direction shall have effect accordingly.

8. The provisions set out in the Third Schedule to this Order, being provisions of Part III of the Act adapted and modified for the purposes of this Order, shall apply in relation thereto.

9. Subject to the provisions of this Order, any person who has suffered loss or damage in consequence of any refusal (including revocation or modification) of consent under this Order or of any grant of any such consent subject to conditions, shall, if he makes a claim on the Authority within the time and in the manner prescribed by this Order, be entitled to recover from the Authority compensation in respect of such loss or damage:

Provided that no compensation shall be payable in respect of loss or damage suffered by reason of such refusal or grant of consent in the case of any trees the subject of a certificate in accordance with Article 5 of this Order.

10. In assessing compensation payable under the last preceding Article, account shall be taken of:-

- (a) any compensation or contribution which has been paid whether to the claimant or any other person, in respect of the same trees under the terms of this or any other Tree Preservation Order under Section 60 of the Act or under Section 29 of the Town and Country Planning Act 1962 or under the terms of any Interim Preservation Order made under Section 8 of the Town and Country Planning (Interim Development) Act 1943, or any compensation which has been paid or which could have been claimed under any provision relating to the preservation of trees or protection of woodlands contained in an operative scheme under the Town and Country Planning Act 1932, and
- (b) any injurious affection to any land of the owner which would result

from the felling of the trees the subject of the claim

11. (1) A claim for compensation under this Order shall be in writing and shall be made by serving it on the Authority, such service to be effected by delivering the claim at the offices of the Authority addressed to the Clerk thereof or by sending it by prepaid post so addressed.

(2) The time within which any such claim shall be made as aforesaid shall be a period of twelve months from the date of the decision of the Authority, or of the Secretary of State, as the case may be, or where an appeal has been made to the Secretary of State against the decision of the Authority, from the date of the decision of the Secretary of State on the appeal.

12. Any question of disputed compensation shall be determined in accordance with the provisions of Section 179 of the Act.

13. The provisions of Section 61 of the Act shall apply to this Order and the Order shall take effect on the Twenty third day of March 1973.

14. This Order may be cited as "The Borough of Keighley (Tarnwood House) Tree Preservation Order 1973".

NOTE: Any person contravening the provisions of this Order is guilty of an offence under subsection (1) of Section 102 of the Act and liable on summary conviction to a fine not exceeding Two hundred and fifty pounds; and if in the case of a continuing offence the contravention is continued after conviction he is guilty of a further offence thereunder and liable on summary conviction to an additional fine not exceeding Two pounds for every day on which the contravention is so continued. Under Sections 62, 102 and 103 of the Act if a tree is wilfully cut down or destroyed or if topping or lopping is carried out in such a way as to be likely to destroy the tree the fine is Two hundred and fifty pounds or twice the value of the tree whichever is the greater. If a tree other than one which is part of woodland is removed or destroyed in contravention of the Order it is the duty of the owner of the land, unless on his application the local authority dispense with the requirement, to plant another tree of appropriate size and species, at the same place as soon as he reasonably can.

PAGE 6 MISSING.

<u>No. on Map</u>	<u>Description</u>	<u>Situation</u>
(T.10)	Sycamore	Land within the boundaries of Tarnwood House, Black Hill Lane shown on Ordnance Sheet SE 0442. Grid Reference 04394203
(T.11)	Sycamore	Land within the boundaries of Tarnwood House, Black Hill Lane shown on Ordnance Sheet SE 0442. Grid Reference 04404204
(T.12)	Sycamore	Land within the boundaries of Tarnwood House, Black Hill Lane shown on Ordnance Sheet SE 0442. Grid Reference 04404204
(T.13)	Sycamore	Land within the boundaries of Tarnwood House, Black Hill Lane shown on Ordnance Sheet SE 0442. Grid Reference 04414204
(T.14)	Sycamore	Land within the boundaries of Tarnwood House, Black Hill Lane shown on Ordnance Sheet SE 0442. Grid Reference 04424206
(T.15)	Beech	Land within the boundaries of Tarnwood House, Black Hill Lane shown on Ordnance Sheet SE 0442. Grid Reference 04434207
(T.16)	Sycamore	Land within the boundaries of Tarnwood House, Black Hill Lane shown on Ordnance Sheet SE 0442. Grid Reference 04434207
(T.17)	Sycamore	Land within the boundaries of Tarnwood House, Black Hill Lane shown on Ordnance Sheet SE 0442. Grid Reference 04444208
(T.18)	Sycamore	Land within the boundaries of Tarnwood House, Black Hill Lane shown on Ordnance Sheet SE 0442. Grid Reference 04444208
(T.19)	Sycamore	Land within the boundaries of Tarnwood House, Black Hill Lane shown on Ordnance Sheet SE 0442. Grid Reference 04454208

<u>No on Map</u>	<u>Description</u>	<u>Situation</u>
(T.20)	Sycamore	Land within the boundaries of Tarnwood House, Black Hill Lane shown on Ordnance Sheet SE 0442. Grid Reference 04454209
(T.21)	Horse Chestnut	Land within the boundaries of Tarnwood House, Black Hill Lane shown on Ordnance Sheet SE 0442. Grid Reference 04444208
(T.22)	Beech	Land within the boundaries of Tarnwood House, Black Hill Lane shown on Ordnance Sheet SE 0442. Grid Reference 04444207
(T.23)	Beech	Land within the boundaries of Tarnwood House, Black Hill Lane shown on Ordnance Sheet SE 0442. Grid Reference 04444206
(T.24)	Sycamore	Land within the boundaries of Tarnwood House, Black Hill Lane shown on Ordnance Sheet SE 0442. Grid Reference 04434206
(T.25)	Beech	Land within the boundaries of Tarnwood House, Black Hill Lane shown on Ordnance Sheet SE 0442. Grid Reference 04434205
(T.26)	Sycamore	Land within the boundaries of Tarnwood House, Black Hill Lane shown on Ordnance Sheet SE 0442. Grid Reference 04424204.
(T.27)	Beech	Land within the boundaries of Tarnwood House, Black Hill Lane shown on Ordnance Sheet SE 0442. Grid Reference 04414204
(T.28)	Sycamore	Land within the boundaries of Tarnwood House, Black Hill Lane shown on Ordnance Sheet SE 0442. Grid Reference 04414203
(T.29)	Sycamore	Land within the boundaries of Tarnwood House, Black Hill Lane shown on Ordnance Sheet Se 0442. Grid Reference 04404203

<u>No. on Map</u>	<u>Description</u>	<u>Situation</u>
(T.30)	Sycamore	Land within the boundaries of Tarnwood House, Black Hill Lane shown on Ordnance Sheet SE 0442. Grid Reference 04394202
(T.31)	Sycamore	Land within the boundaries of Tarnwood House, Black Hill Lane shown on Ordnance Sheet SE 0442. Grid Reference 04394202
(T.32)	Sycamore	Land within the boundaries of Tarnwood House, Black Hill Lane shown on Ordnance Sheet SE 0442. Grid Reference 04394201
(T.33)	Sycamore	Land within the boundaries of Tarnwood House, Black Hill Lane shown on Ordnance Sheet SE 0442. Grid Reference 04384201
(T.34)	Mountain Ash	Land within the boundaries of Tarnwood House, Black Hill Lane shown on Ordnance Sheet SE 0442. Grid Reference 0438-200
(T.35)	Sycamore	Land within the boundaries of Tarnwood House, Black Hill Lane shown on Ordnance Sheet SE 0442. Grid Reference 04374199
(T.36)	Sycamore	Land within the boundaries of Tarnwood House, Black Hill Lane shown on Ordnance Sheet SE 0442. Grid Reference 04374199
(T.37)	Sycamore	Land within the boundaries of Tarnwood House, Black Hill Lane shown on Ordnance Sheet SE 0442. Grid Reference 04374198
(T.38)	Sycamore	Land within the boundaries of Tarnwood House, Black Hill Lane shown on Ordnance Sheet SE 0442. Grid Reference 0436-198
(T.39)	Hawthorn	Land within the boundaries of Tarnwood House, Black Hill Lane shown on Ordnance Sheet SE 0442. Grid Reference 04364197

TREES SPECIFIED BY REFERENCES TO AN AREA
(within a dotted black line on the map)

NONE

GROUPS OF TREES
(within a broken black line on the map)

NONE

WOODLANDS
(within a continuous black line on the map)

NONE

SECOND SCHEDULE

This Order shall not apply so as to require the consent of the Authority to

- (1) the cutting down of any tree on land which is subject to a forestry dedication covenant where
 - (a) any positive covenants on the part of the owner of the land contained in the same deed as the forestry dedication covenant and at the time of the cutting down binding on the then owner of the land are fulfilled;
 - (b) the cutting down is in accordance with a plan of operations approved by the Forestry Commission under such deed.
- (2) the cutting down of any tree which is in accordance with a plan of operations approved by the Forestry Commission under the approved woodlands scheme.
- (3) the cutting down, topping or lopping of a tree exempted from the provisions of this Order by Section 60(6) of the Act namely a tree which is dying or dead or has become dangerous, or the cutting down, topping or lopping of which is in compliance with obligations imposed by or under an Act of Parliament or so far as may be necessary for the prevention or abatement of a nuisance.
- (4) the cutting down, topping or lopping of a tree
 - (a) in pursuance of the power conferred on the Minister of Posts and Telecommunications by virtue of Section 5 of the Telegraph (Construction) Act 1908;
 - (b) by or at the request of
 - (i) a statutory undertaker where the land on which the tree is situated is operational land as defined by the Act and either works on such land cannot otherwise be carried out or the cutting down, topping or lopping is for the purpose of securing safety in the operation of the undertaking;
 - (ii) an electricity board within the meaning of the Electricity Act 1947 where such tree obstructs the construction of the Board of any main transmission line or other electric line within the meaning respectively of the Electricity (Supply) Act 1919 and the Electric Lighting Act 1882 or interferes or would interfere with the maintenance or working of any such line;

PAGE 12 MISSING.

35. (3) Any application in respect of which a direction under this section has effect shall be referred to the Secretary of State accordingly.

35. (4) Where an application for consent under the Order is referred to the Secretary of State under this section, the provisions of Articles 4 and 5 of the Order shall apply as they apply to an application which falls to be determined by the Authority.

35. (5) Before determining an application referred to him under this section the Secretary of State shall, if either the applicant or the Authority so desire, afford to each of them an opportunity of appearing before, and being heard by, a person appointed by the Secretary of State for the purpose.

35. (6) The decision of the Secretary of State on any application referred to him under this section shall be final.

36. (1) Where an application is made to the Authority for consent under the Order and that consent is refused by that Authority or is granted by them subject to conditions, or where any certificate or direction is given by the Authority, the applicant, if he is aggrieved by their decision on the application, or by any such certificate, or the person directed if he is aggrieved by the direction, may by notice under this section appeal to the Secretary of State.

36. (2) A notice under this section shall be served in writing within twenty-eight days from the receipt of notification of the decision, certificate or direction, as the case may be, or such longer period as the Secretary of State may allow.

36. (3) Where an appeal is brought under this section from a decision, certificate or direction of the Authority, the Secretary of State, subject to the following provisions of this section, may allow or dismiss the appeal, or may reverse or vary any part of the decision of the Authority, whether the appeal relates to that part thereof or not, or may cancel any certificate or cancel or vary any direction, and may deal with the application as if it had been made to him in the first instance.

36. (4) Before determining an appeal under this section, the Secretary of

State shall, if either the appellant or the Authority so desire, afford to each of them an opportunity of appearing before, and being heard by, a person appointed by the Secretary of State for the purpose.

36. (6) The decision of the Secretary of State on any appeal under this section shall be final.

37. Where an application for consent under the Order is made to the Authority, then unless within two months from the date of receipt of the application, or within such extended period as may at any time be agreed upon in writing between the applicant and the Authority, the Authority either -

(a) give notice to the applicant of their decision on the application; or

(b) give notice to him that the application has been referred to the

Secretary of State in accordance with directions given under section 35 above;

the provisions of the last preceding section shall apply in relation to the application as if the consent to which it relates had been refused by the Authority, and as if notification of their decision had been received by the applicant at the end of the said period of two months, or at the end of the said extended period, as the case may be.

45. (1) If it appears to the Authority that it is expedient to revoke or modify any consent under the Order granted on an application made under Article 3 of the Order, the Authority may by order revoke or modify the consent to such extent as they consider expedient.

45. (2) (Except as provided in sections 46 and 61 of the Act) an Order under this section shall not take effect unless it is confirmed by the Secretary of State; and the Secretary of State may confirm any such Order submitted to him either without modification or subject to such modifications as he considers expedient.

45. (3) Where the Authority submit an Order to the Secretary of State for his confirmation under this section, the Authority shall furnish the Secretary of State with a statement of their reason for making the Order and shall serve notice together with a copy of the aforesaid statement on the owner and on the

will be affected by the Order, and if within the period of twenty-eight days from the service thereof any person on whom the notice is served so requires, the Secretary of State, before confirming the Order, shall afford to that person, and to the Authority, an opportunity of appearing before, and being heard by, a person appointed by the Secretary of State for the purpose.

45. (4) The power conferred by this section to revoke or modify a consent may be exercised at any time before the operations for which consent has been given have been completed:

Provided that the revocation or modification of consent shall not affect so much of those operations as has been previously carried out.

45. (5) Where a notice has been served in accordance with the provisions of sub-section (3) of this section, no operations or further operations as the case may be, in pursuance of the consent granted, shall be carried out pending the decision of the Secretary of State under sub-section (2) of this section.

46. (1) The following provisions shall have effect where the Authority have made an Order (hereinafter called "such Order") under section 45 above revoking or modifying any consent granted on an application made under a tree preservation order but have not submitted such Order to the Secretary of State for confirmation by him and the owner and the occupier of the land and all persons who in the Authority's opinion will be affected by such Order have notified the Authority in writing that they do not object to such Order.

46. (2) The Authority shall advertise the fact that such Order has been made and the advertisement shall specify (a) the period (not less than twenty-eight days from the date on which the advertisement first appears) within which persons affected by such Order may give notice to the Secretary of State that they wish for an opportunity of appearing before, and being heard by, a person appointed by the Secretary of State for the purpose; and (b) the period (not less than fourteen days from the expiration of the period referred to in paragraph (a) above) at the expiration of which, if no such notice is given to the Secretary of State, such Order may take effect by virtue of this section and without

being confirmed by the Secretary of State.

46. (3) The Authority shall also serve notices to the same effect on the persons mentioned in sub-section (1) above.

46. (4) The Authority shall send a copy of any advertisement published under sub-section (2) above to the Secretary of State, not more than three days after the publication.

46. (5) If within the period referred to in sub-section (2)(a) above no person claiming to be affected by such Order has given notice to the Secretary of State as aforesaid and the Secretary of State has not directed that such Order be submitted to him for confirmation, such Order shall at the expiration of the period referred to in sub-section (2)(b) of this section take effect by virtue of this section and without being confirmed by the Secretary of State as required by section 45 (2) of the Act.

46. (6) This section does not apply to such Order revoking or modifying a consent granted or deemed to have been granted by the Secretary of State under Part III or Part IV or Part V of this Act; nor does it apply to an Order modifying any conditions to which a consent is subject by virtue of sections 41 and 42 of the Act.

GIVEN under the Common Seal of the Mayor Aldermen and Burgesses of the Borough of Keighley this *Twenty third* day of *March* 1973.

THE COMMON SEAL of the Mayor)
Aldermen and Burgesses of the)
Borough of Keighley was here-)
unto affixed in the presence)
of:-)

W. A. Pinner

Mayor

[Signature]

Town Clerk



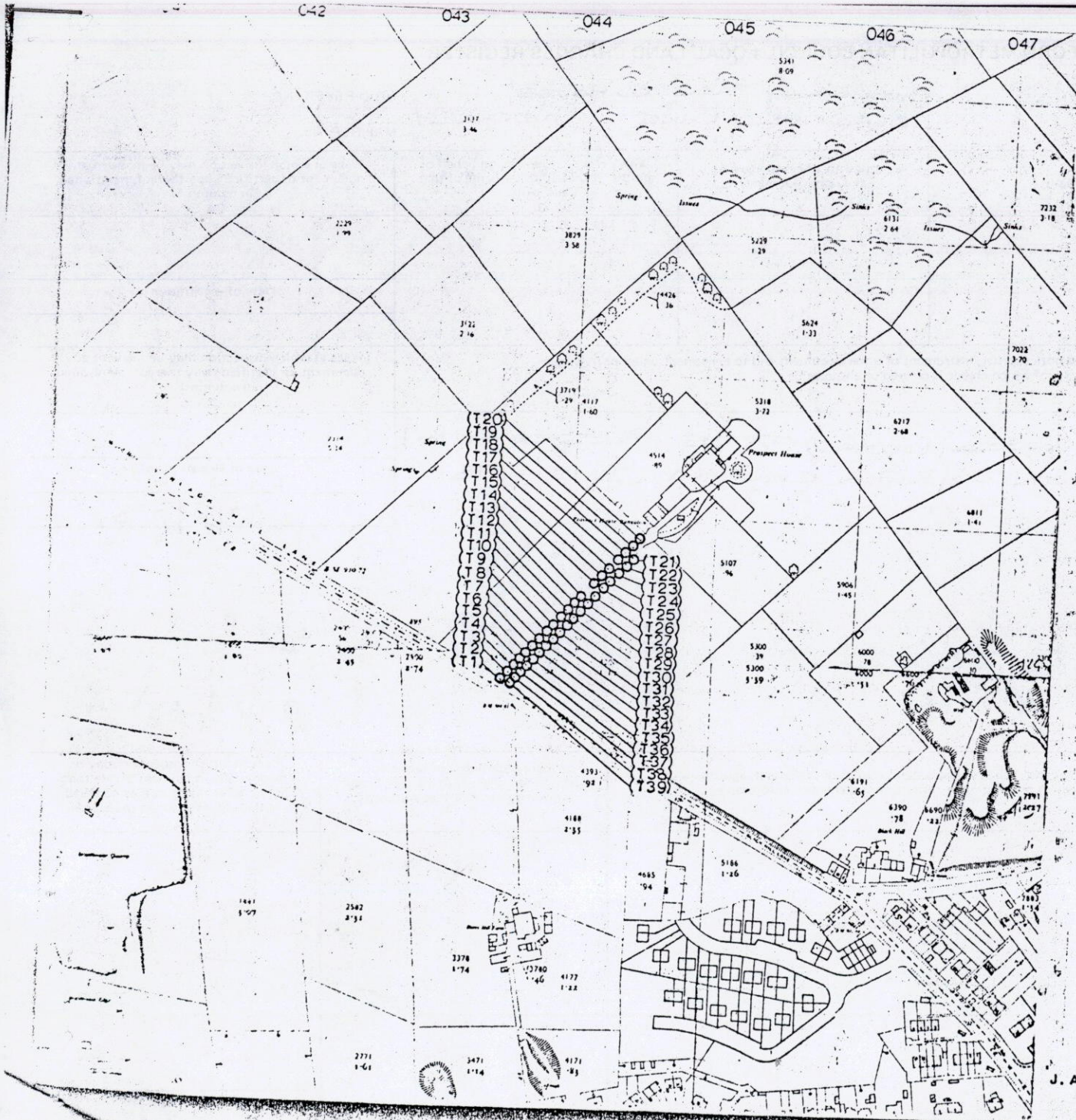

KEIGHLEY BOROUGH (Tarnwood House)

COUNTY COUNCIL OF THE WEST RIDING OF YORKSHIRE

TREE PRESERVATION ORDER NO 1 1973



J. A. CAESAR, TOWN CLERK, TOWN HALL, KEIGHLEY.

CITY OF BRADFORD METROPOLITAN COUNCIL LOCAL LAND CHARGES REGISTER

Signature _____ Local Registrar _____ Description of Property **"TARNWOOD HOUSE"** GRID REFERENCE _____
BLACKHILL LANE KEIGHLEY MAP REF. No. _____

PART 3 PLANNING CHARGES	Description of land affected - (including particulars of planning decision) 1	Particulars of compensation and apportionment. 2	Where charge registered on behalf of another local authority, name of that authority. 3	Place at which inspection may be made of any document or certified copy thereof, mentioned in column 1. 4
(a) Notices deposited under S. 158 TCP Act 1971				Date of registration 5
(b) OTHER PLANNING CHARGES	Nature of charge and reference to notice, order, instrument or other document and to enactment under or by virtue of which charge is created or enforceable. 1			Place at which inspection may be made of any document, or certified copy thereof, mentioned in column 1. 2

Borough of Keighley (Tarnwood House) Tree Preservation
Order No. 1 1973 made on 23/3/73 confirmed 18/5/73 ✓
 ?

Date of Registration
3
19/5/73

THIS IS
149 per list

Part 4 MISCELLANEOUS PROHIBITIONS AND RESTRICTIONS	Nature of prohibition or restriction: reference to order, scheme, instrument, resolution, covenant, agreement or other document, under or by virtue of which prohibition or restriction is created or enforceable. 1	Where prohibition or restriction registered on behalf of another Local Authority name of that Authority. 2	Place at which inspection may be made of any document (other than public general statute), or certified copy thereof, mentioned in column 1. 3
		No Data on computer	Date of Registration 4